

S Series



Capacity:

10-200 ton

Stroke:

25-150mm

Maximum Operating Pressure:

700 bar

S 液壓單動，標準型千斤頂

- 可360度全方位使用設計。
- 主軸及液壓缸內壁硬鉻處理耐磨、抗腐蝕；並能增加密封性及使用壽命。
- 強力彈簧加速主軸回縮速度。
- 特殊軟質環設計，防止主軸偏心荷載；避免磨耗刮傷油缸。
- 防塵環減少污染物附著。
- 上螺帽保護主軸超揚昇。
- 表面粉體塗裝美觀抗腐蝕、防銹。
- 各型號均會SQB-3/8UF快速接頭及防塵蓋。

Single-Acting, General Cylinders

※ Designed for use in all positions.

※ Hard chrome plated plunger and inner of barrel resists wear and corrosion, it also be more closed and extending cylinder life.

※ Maximum sized springs speed piston return and increase spring life.

※ Special soft ring reduces wear caused by off-center loads.

※ Plunger wiper reduces contaminant.

※ Stop ring for piston blow-out protection.

※ Powder coat finish for increased corrosion resistance and antirust.

※ All cylinders are equipped with SQB-3/8UF female coupler & dust cap.

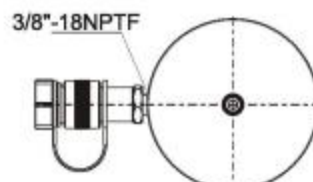
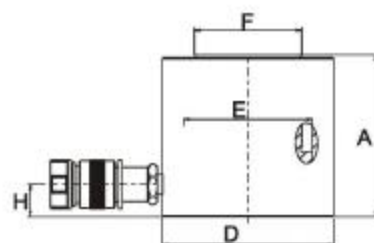

通用S系列 擡程25mm
Stroke 25mm model.

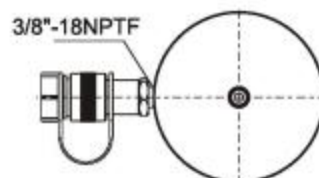
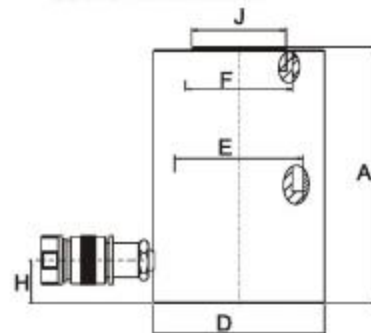

通用S系列 擡程50mm以上
Stroke above to 50mm model.

	焊提把 Weldable		活動提把 Removable strap handles
	吊環螺栓 Eyebolt		螺牙式活動提把 Thread

提把型式 Handle type	
(S) : 標準配件 standard equipped	
(O) : 選配 option	
● 焊提把 Weldable	▲ 活動提把 Removable strap handles
★ 吊環螺栓 Eyebolt	■ 螺牙式活動提把 Thread

提把型式 Handle type	型號 Model Number	外部尺寸 Outer Dimension											
		能力 Cylinder Capacity	揚程 Stroke	受壓面積 Effective Area	總油量 Oil Capacity	本身高 Collapsed Height	伸長總高 Extended Height	外徑 Outside Dia.	內徑 Cylinder Bore Dia.	主軸直徑 Plunger Dia.	底部前進油孔位置 Base to Adv. Port	量塊直徑 Saddle Dia.	重量 Weight
		ton (kN)	(mm)	(cm ²)	(cm ³)	A (mm)	(mm)	D (mm)	E (mm)	F (mm)	H (mm)	J (mm)	(kg)
	S10-25	10 (101)	25.0	14.46	36.1	80.0	105.0	70.0	42.93	38.1	19.5	—	2.4
	S10-50		50.0	14.46	72.3	130.0	180.0	57.0	42.93	38.1	19.5	—	2.5
	S10-75		75.0	14.46	108.4	155.0	230.0	57.0	42.93	38.1	19.5	35	3.1
	S10-100		100.0	14.46	144.6	180.0	280.0	57.0	42.93	38.1	19.5	35	3.4
	S10-125		125.0	14.46	180.7	205.0	330.0	57.0	42.93	38.1	19.5	35	4.0
	S10-150		150.0	14.46	216.9	230.0	380.0	57.0	42.93	38.1	19.5	35	4.2
	S20-25	20 (198)	25.0	28.26	70.7	80.0	105.0	90.0	60.00	50.00	17.0	—	3.7
●	S20-50		50.0	28.26	141.3	135.0	185.0	79.0	60.00	50.00	22.0	—	4.9
●	S20-75		75.0	28.26	212.0	160.0	235.0	79.0	60.00	50.00	22.0	40	5.6
●	S20-100		100.0	28.26	282.6	185.0	285.0	79.0	60.00	50.00	22.0	40	6.3
●	S20-125		125.0	28.26	353.3	210.0	335.0	79.0	60.00	50.00	22.0	40	7.0
●	S20-150		150.0	28.26	423.9	235.0	385.0	79.0	60.00	50.00	22.0	40	7.7
	S30-25	30 (294)	25.0	42.00	105.0	85.0	110.0	99.0	73.15	57.15	19.0	—	5.0
	S30-40		40.0	42.00	210.0	85.0	125.0	99.0	73.15	57.15	22.5	—	7.4
●	S30-50		50.0	42.00	210.0	145.0	195.0	99.0	73.15	57.15	22.5	—	7.6
●	S30-75		75.0	42.00	315.0	170.0	245.0	99.0	73.15	57.15	22.5	49.5	7.8
●	S30-100		100.0	42.00	420.0	195.0	295.0	99.0	73.15	57.15	22.5	49.5	8.9
●	S30-125		125.0	42.00	525.0	220.0	345.0	99.0	73.15	57.15	22.5	49.5	10.0
●	S30-150		150.0	42.00	630.0	245.0	395.0	99.0	73.15	57.15	22.5	49.5	11.0
●	S30-55	30 (269)	55.0	38.46	212.0	105.0	160.0	100.0	70.00	60.00	14.0	—	8.0
●	S50-25	50 (498)	25.0	71.21	178.0	95.0	120.0	127.0	95.25	79.50	24.0	—	8.8
●	S50-35		35.0	71.21	356.0	85.0	120.0	127.0	95.25	79.50	24.0	—	9.5
●	S50-50		50.0	71.21	356.0	120.0	170.0	127.0	95.25	79.50	24.0	—	10.5
●	S50-50B		50.0	71.21	356.0	105.0	155.0	127.0	95.25	79.50	19.0	—	9.5
●	S50-75		75.0	71.21	534.0	190.0	265.0	127.0	95.25	79.50	32.0	71.5	16.8
●	S50-100		100.0	71.21	712.0	215.0	315.0	127.0	95.25	79.50	32.0	71.5	18.2
●	S50-125		125.0	71.21	890.1	240.0	365.0	127.0	95.25	79.50	32.0	71.5	19.9
●	S50-150		150.0	71.21	1068.1	265.0	415.0	127.0	95.25	79.50	32.0	71.5	21.4
▲ ●	S100-25	100 (933)	25.0	133.27	333.1	100.0	125.0	177.0	130.30	104.90	20.0	—	16.9
▲ ●	S100-50		50.0	133.27	666.3	160.0	210.0	177.0	130.30	104.90	30.0	84	26.8
▲ ●	S100-100		100.0	133.27	1332.7	204.0	304.0	177.0	130.30	104.90	30.0	84	36.8
▲ ●	S100-125		125.0	133.27	1665.8	235.0	360.0	177.0	130.30	104.90	30.0	84	40.6
▲ ●	S100-150		150.0	133.27	1999.0	260.0	410.0	177.0	130.30	104.90	30.0	84	44.3
▲ ★	S150-50	150 (1407)	50.0	200.96	1004.8	200.0	250.0	215.0	160.00	115.00	50.0	99	50.2
▲ ★	S150-100		100.0	200.96	2009.6	250.0	350.0	215.0	160.00	115.00	50.0	99	60.0
▲ ★	S150-150		150.0	200.96	3014.4	300.0	450.0	215.0	160.00	115.00	50.0	99	68.9
▲ ★	S200-50	200 (1984)	50.0	283.38	1416.9	200.0	250.0	255.0	190.00	135.00	50.0	115	71.6
▲ ★	S200-100		100.0	283.38	2833.0	250.0	350.0	255.0	190.00	135.00	50.0	115	85.0
▲ ★	S200-150		150.0	283.38	4250.7	300.0	450.0	255.0	190.00	135.00	50.0	115	98.5